

OUTPUT**Frequency**

100 MHz

Level

+13 ±2dBm into 50 ohms

STABILITY**Aging**1 x 10⁻⁶ per year

after 30 days operating, typical

Phase Noise L(f)

100 Hz -125 dBc/Hz

1 kHz -150 dBc/Hz

10 kHz -174 dBc/Hz

20 kHz -174 dBc/Hz

Temperature Stability±5 x 10⁻⁷, 0° to +60°C (Ref +25°C)**MECHANICAL****Dimensions**

1.75 x 2.94 x 1"

Connectors

SMA and solder pins on side

Packaging

Solder sealed steel can

POWER REQUIREMENTS**Warm-Up Power**

<5 Watts for 5 minutes

Total Power

2.5 Watts at +25°C

Supply Voltage

+15 VDC

ADJUSTMENT**Mechanical Tuning**±4 x 10⁻⁶**Electrical Tuning**±2 x 10⁻⁷, ±5 VDC

Negative slope

CRYSTAL**Type**

100 MHz SC-cut

REV	DATE	REVISION RECORD	DWN	AUTH
-	11-14-06	Draft	YR	BH

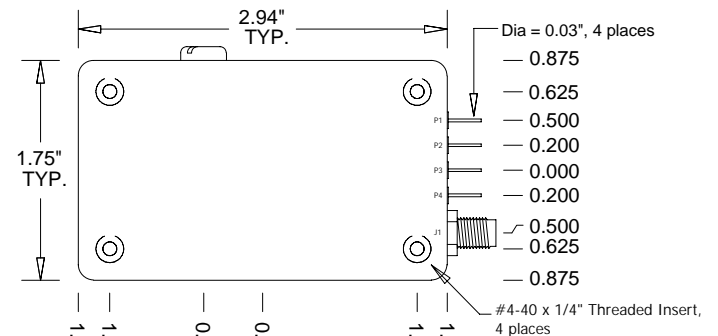
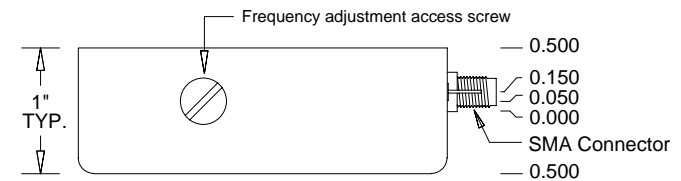

Connector numbers are for reference only, they do not appear on unit.

Conn	Function
J1	RF Output
P1	N/C
P2	Electrical Tuning
P3	Supply Voltage
P4	Case Ground



Wenzel Associates, Inc.

Austin, Texas

Title:

Standard 100 MHz-SC Ultra Low Noise Crystal Osc.

P/N:

501-16842

Rev:

-

Date:

11-14-06

Drawn:

Ref:

Tolerances:
(except as noted)
Dimensions are in inches

0.XX Dec:

±0.030"

0.XXX Dec:

±0.010"

FSCM:

62821

Page 1 of 1